

BIOLOID

Scorpion

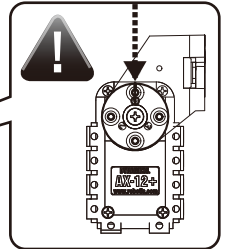

STEP 1

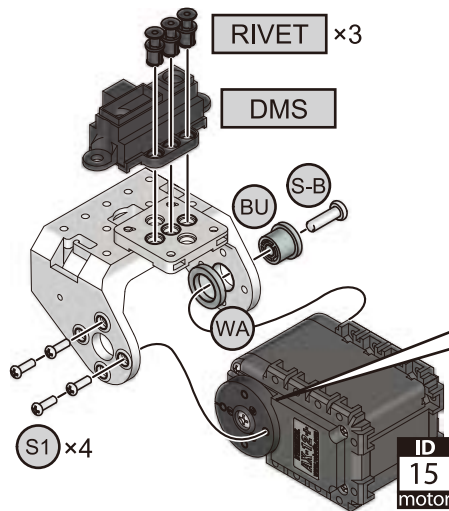
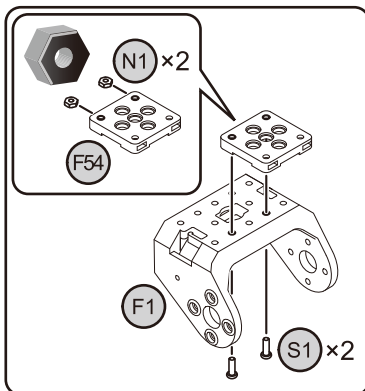

STEP 2

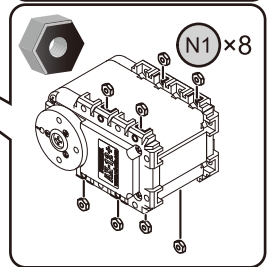
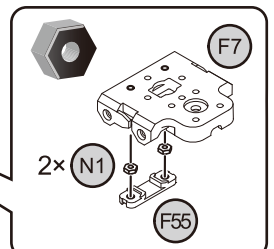
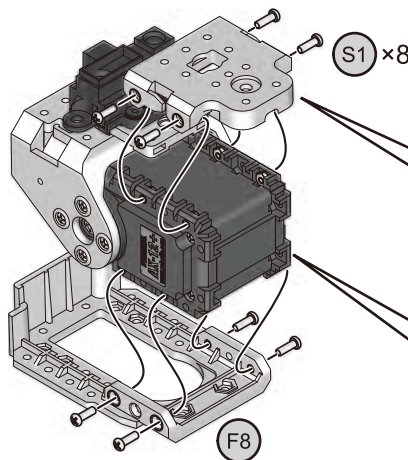
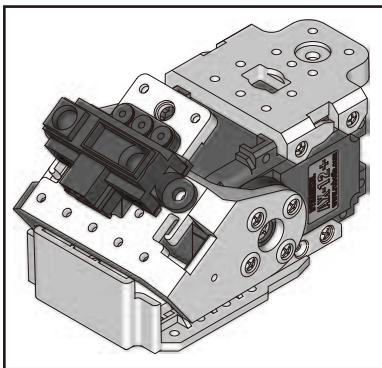

STEP 3

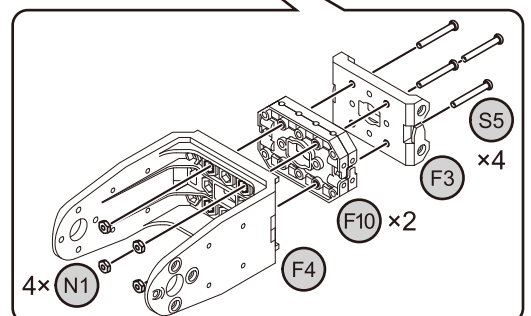
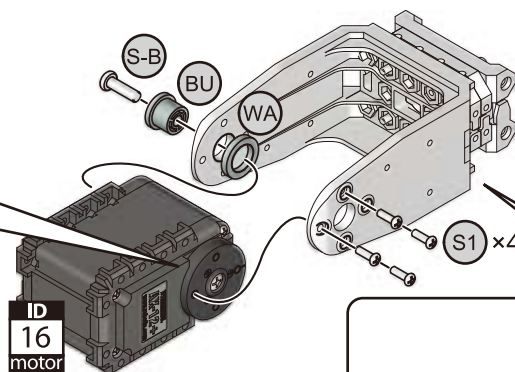
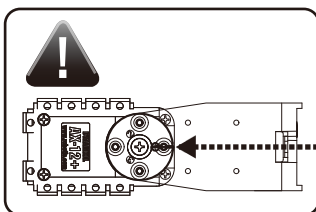

STEP 4

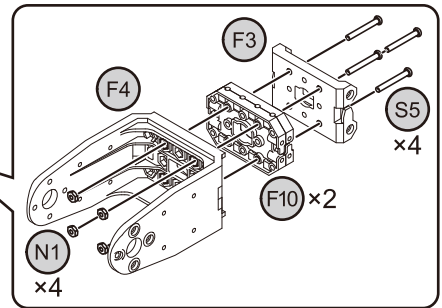
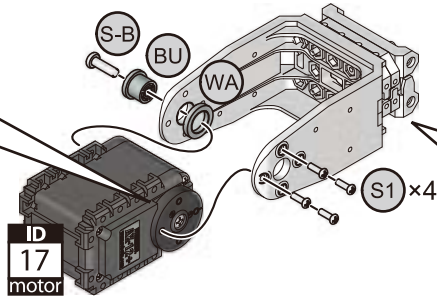
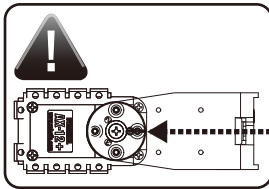

STEP 5

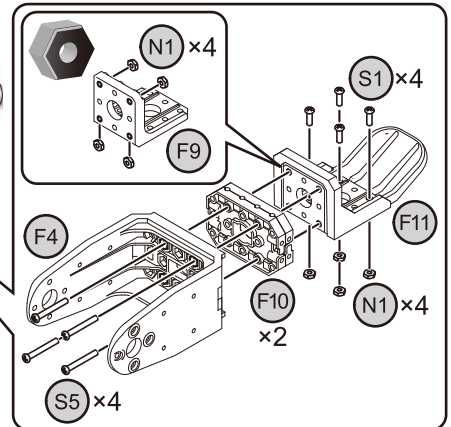
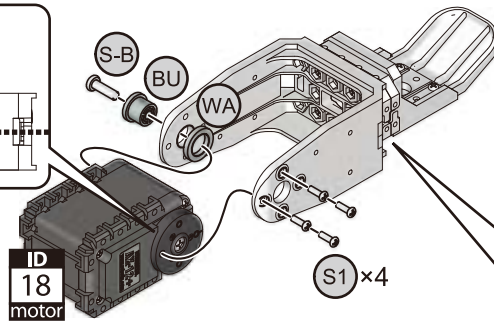
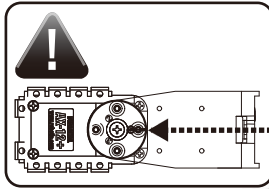

STEP 6

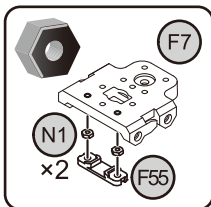

STEP 4

S1 x16

STEP 5

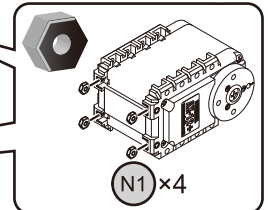
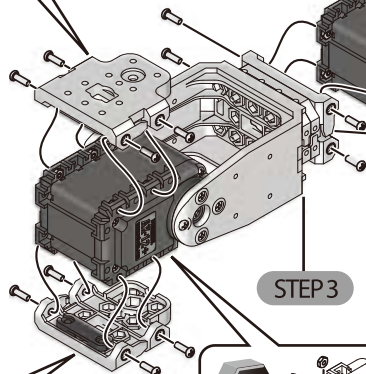

STEP 3

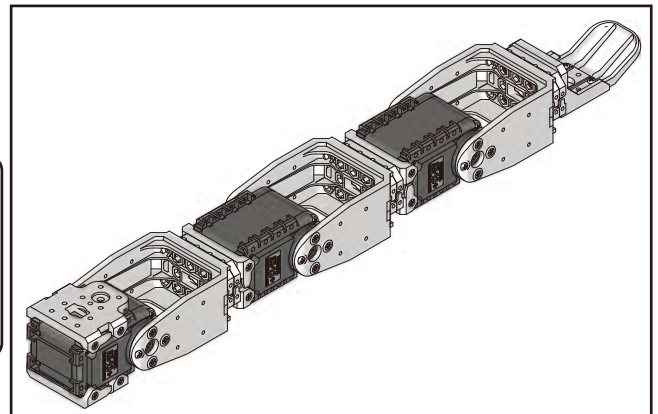
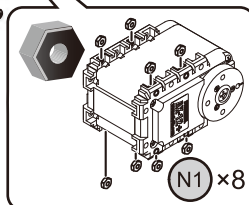
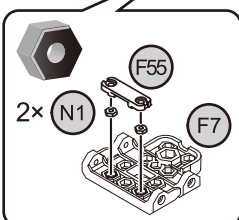

STEP 7

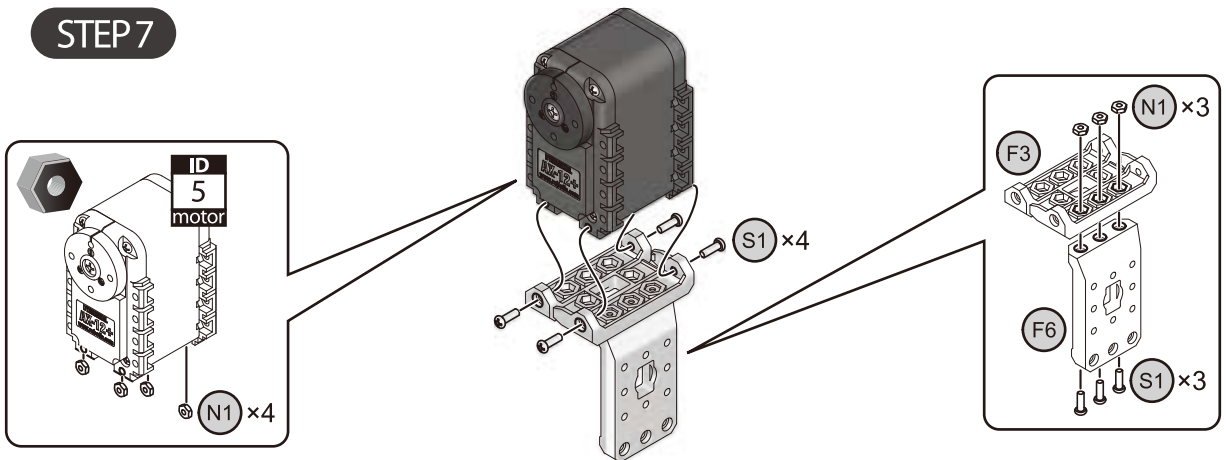

STEP 8

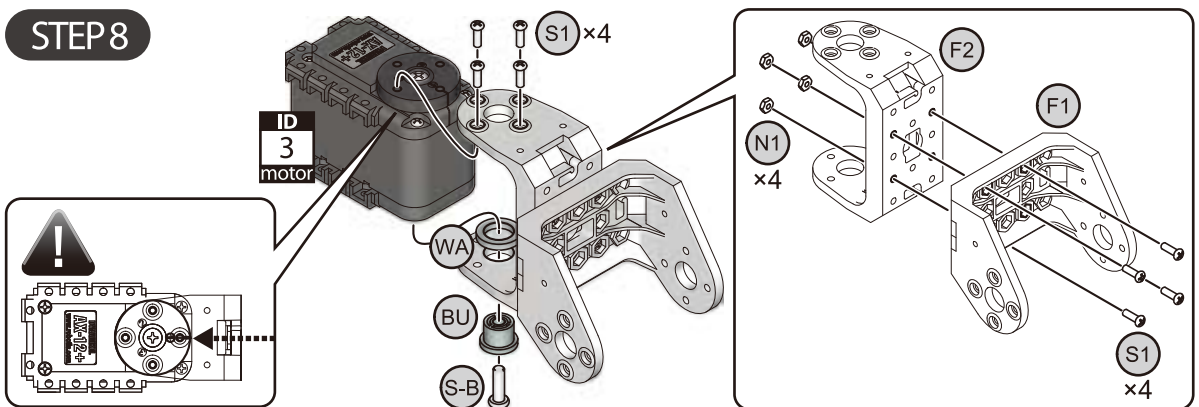

STEP 9

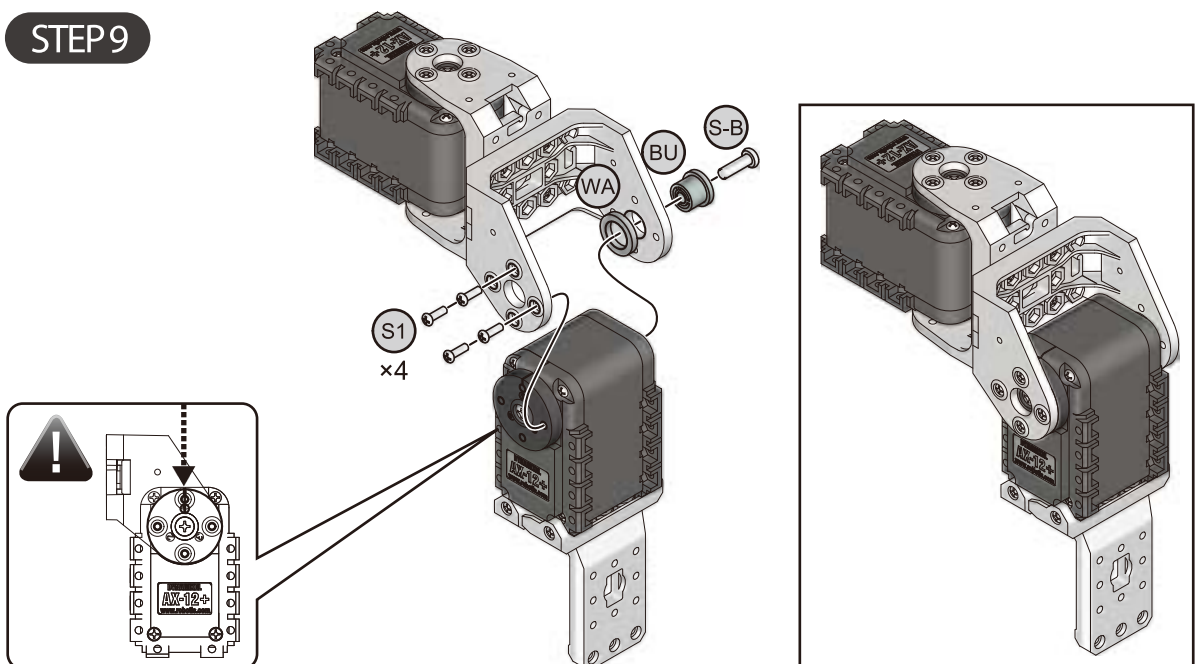

STEP 10

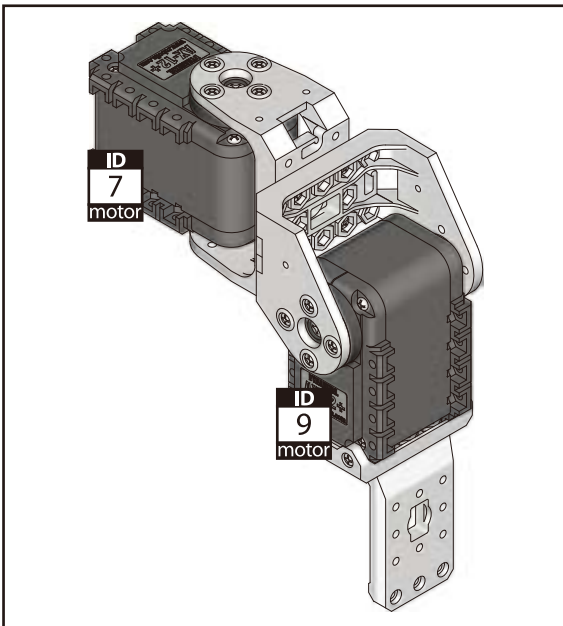

STEP 11

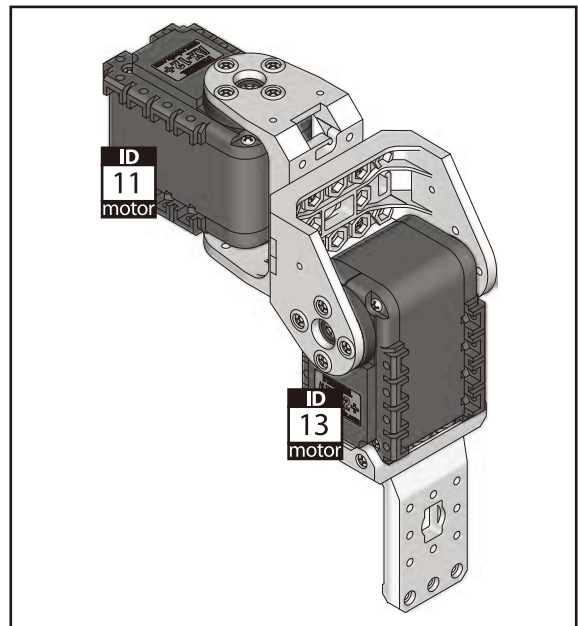

STEP 12

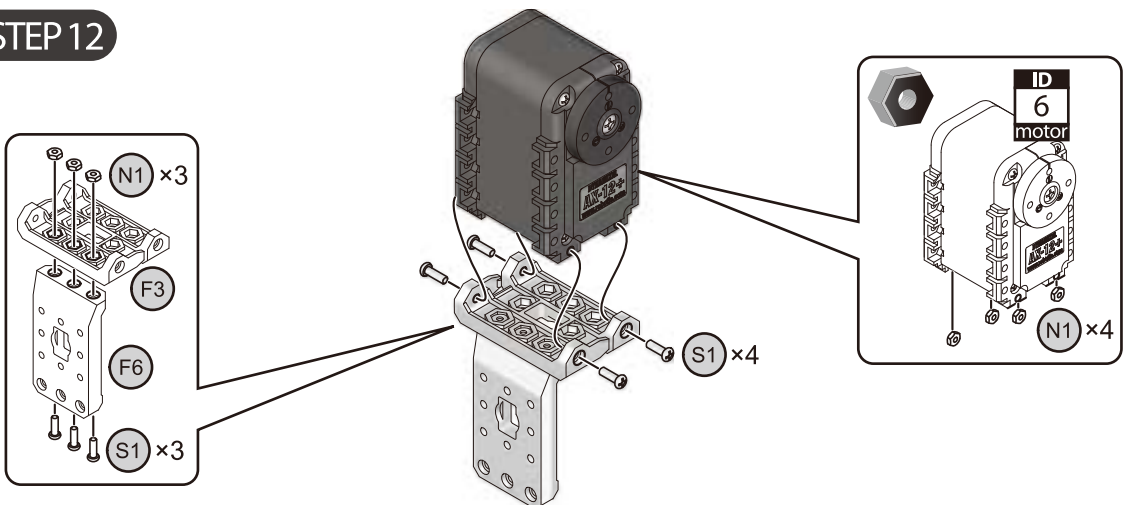

STEP 13

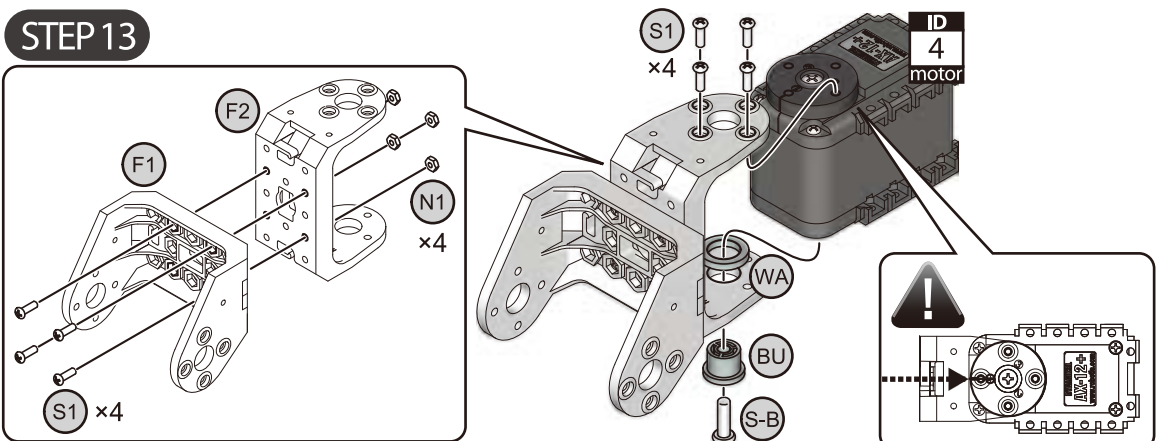

STEP 14

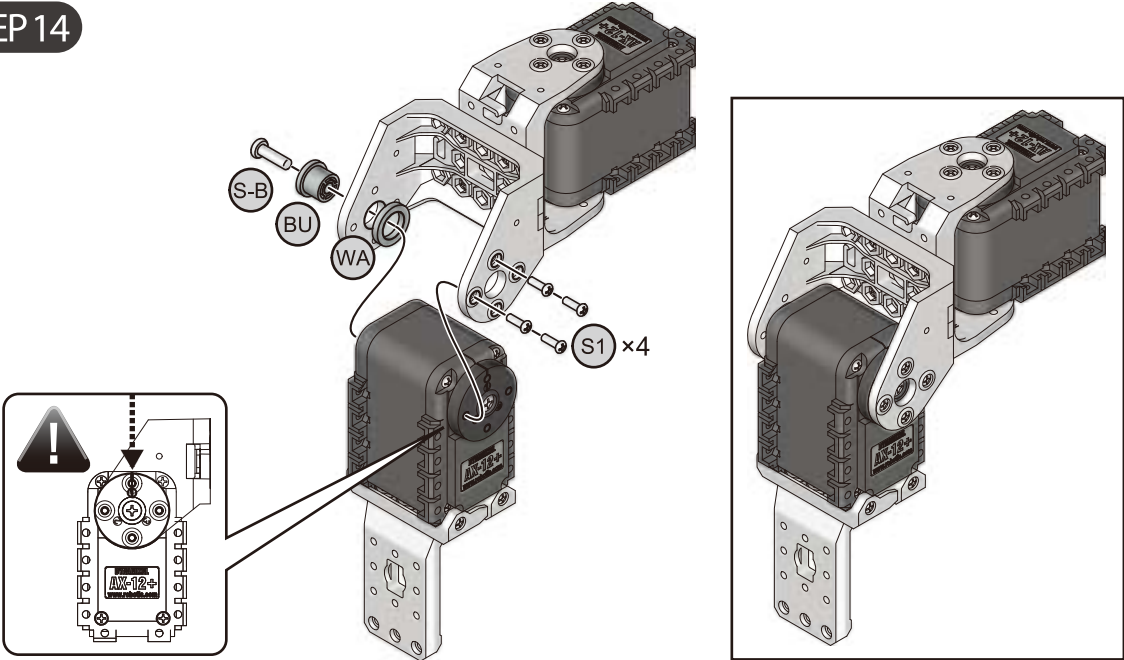

STEP 15

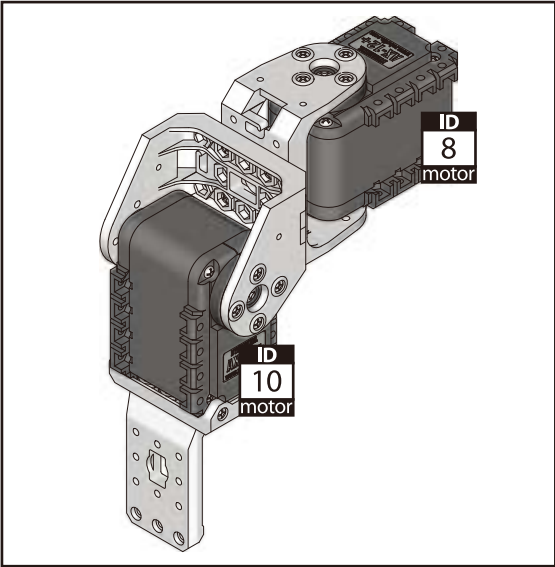

STEP 16

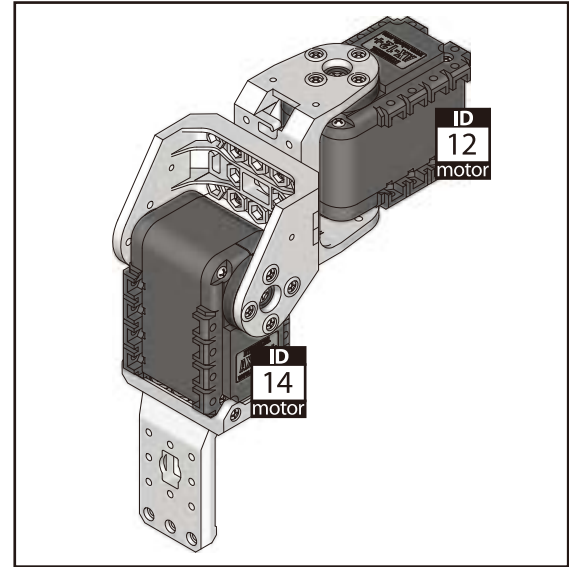

STEP 17

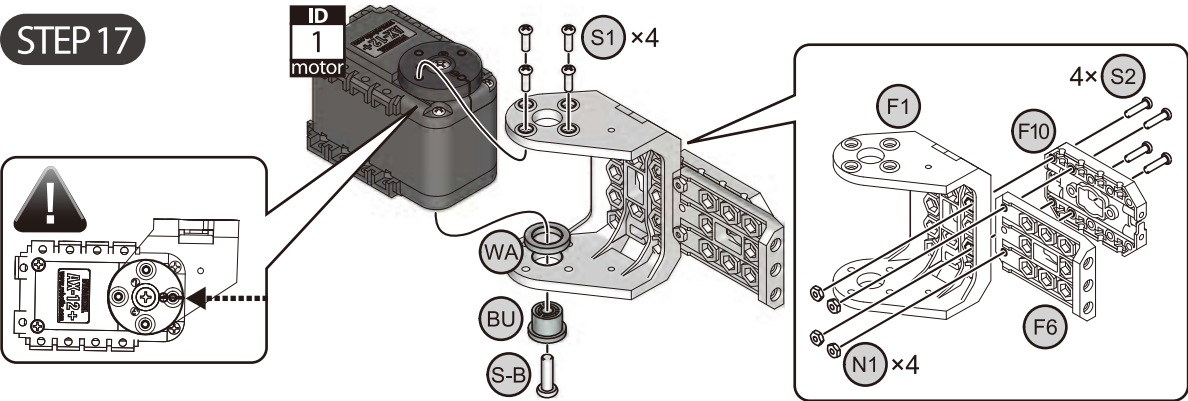

STEP 18

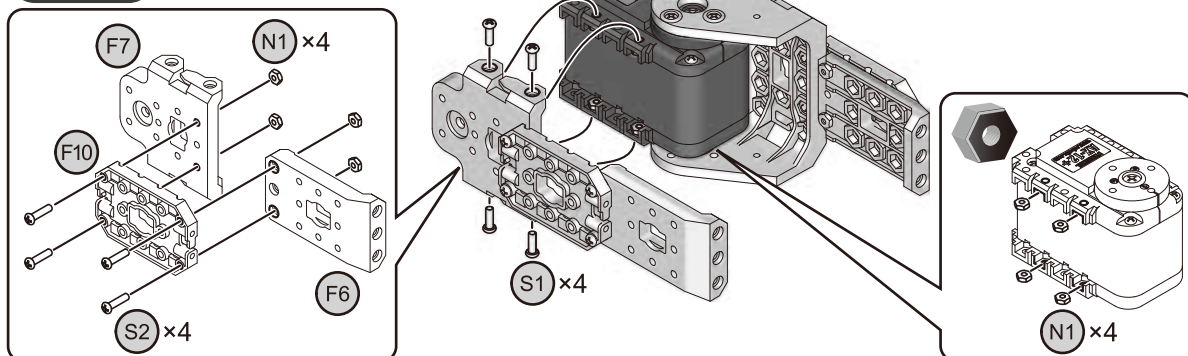

STEP 19

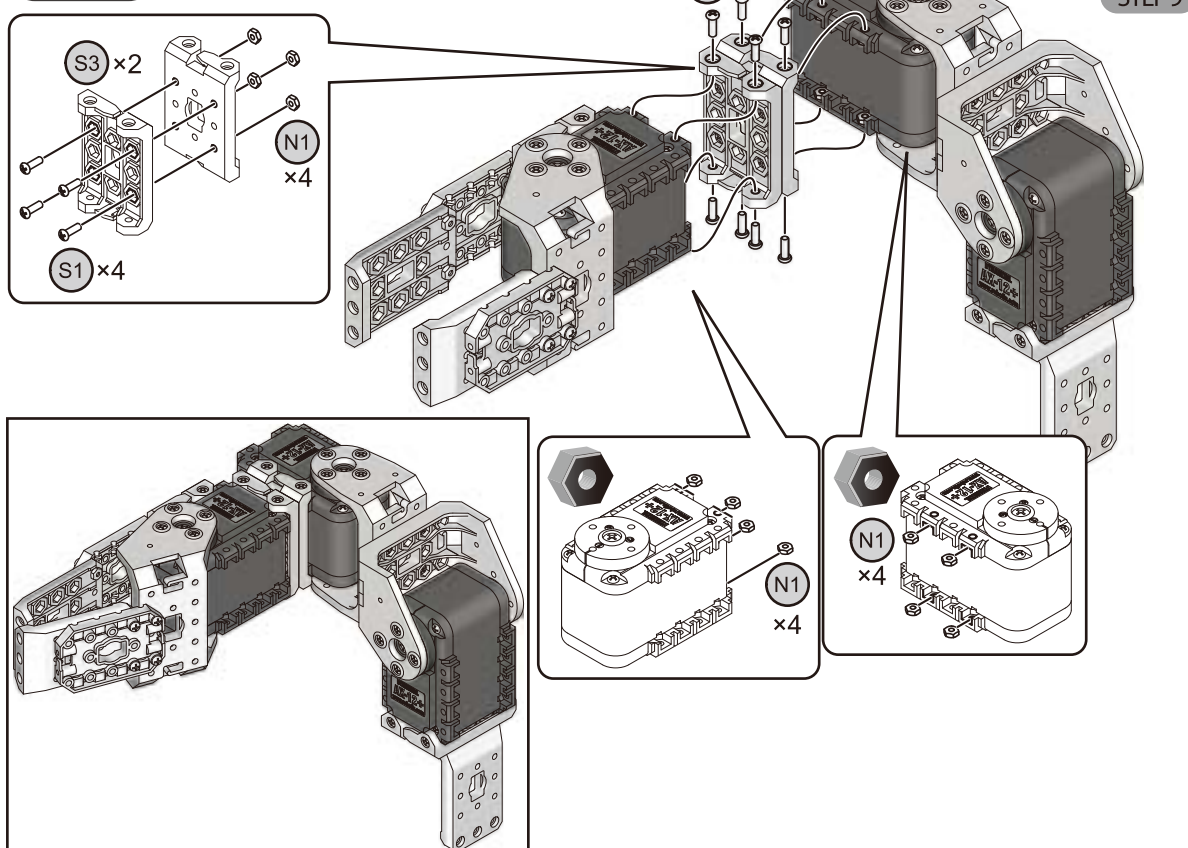

STEP 20

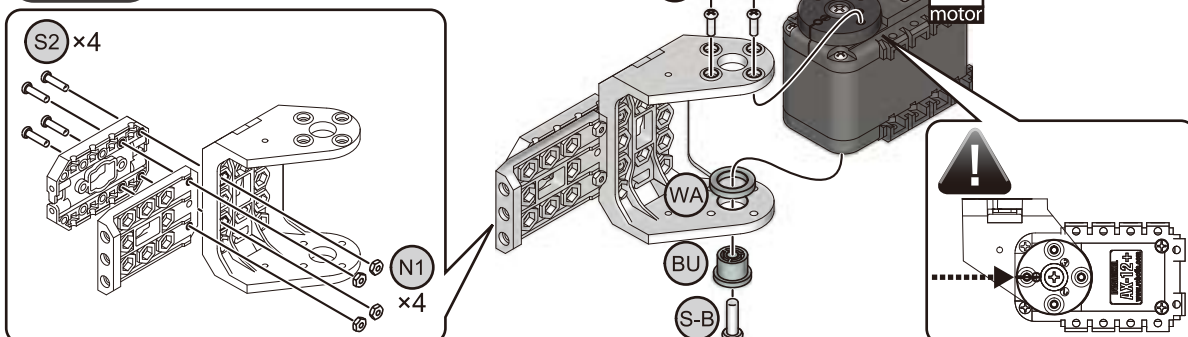

STEP 21

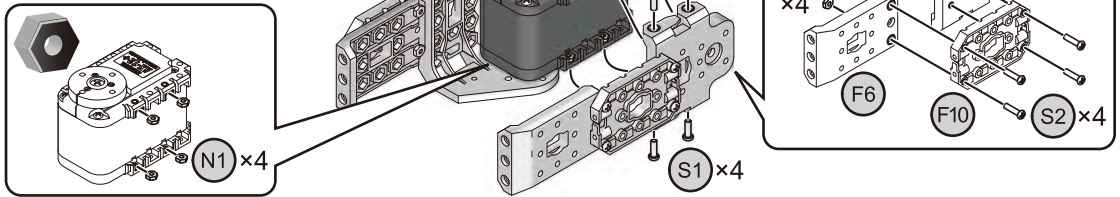

STEP 22

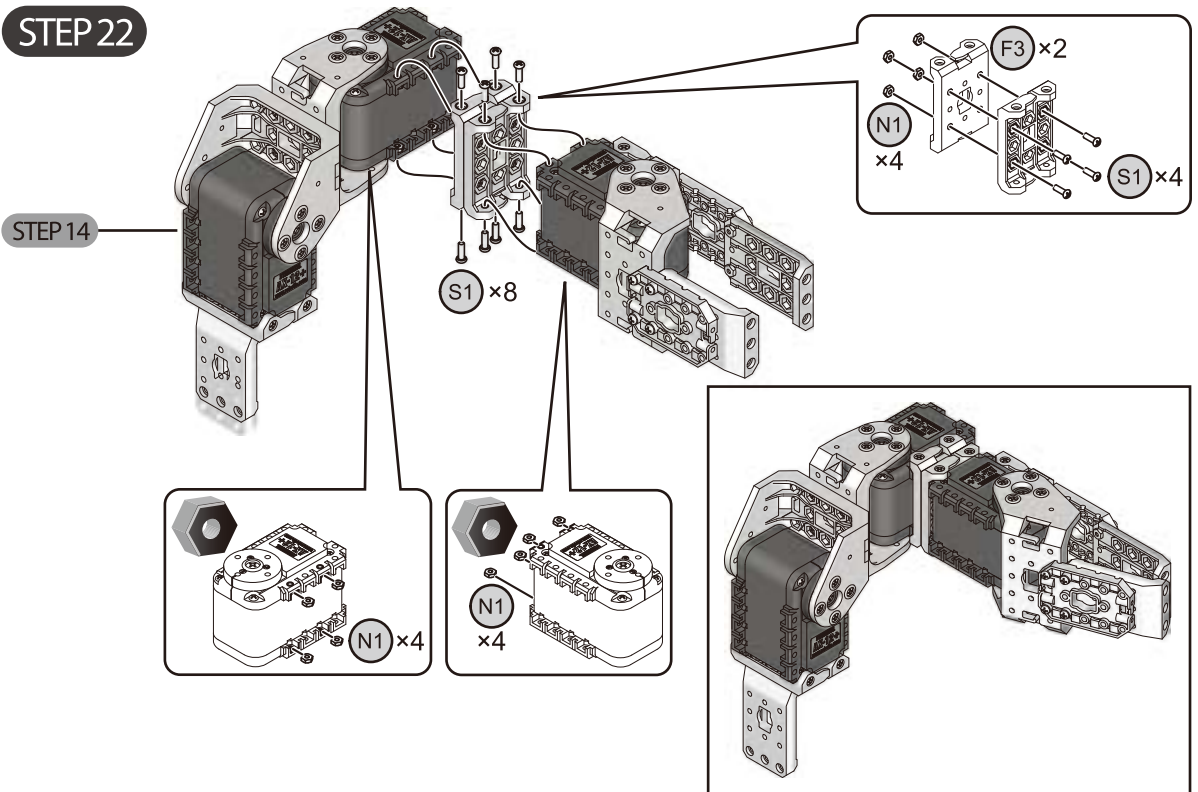

STEP 23

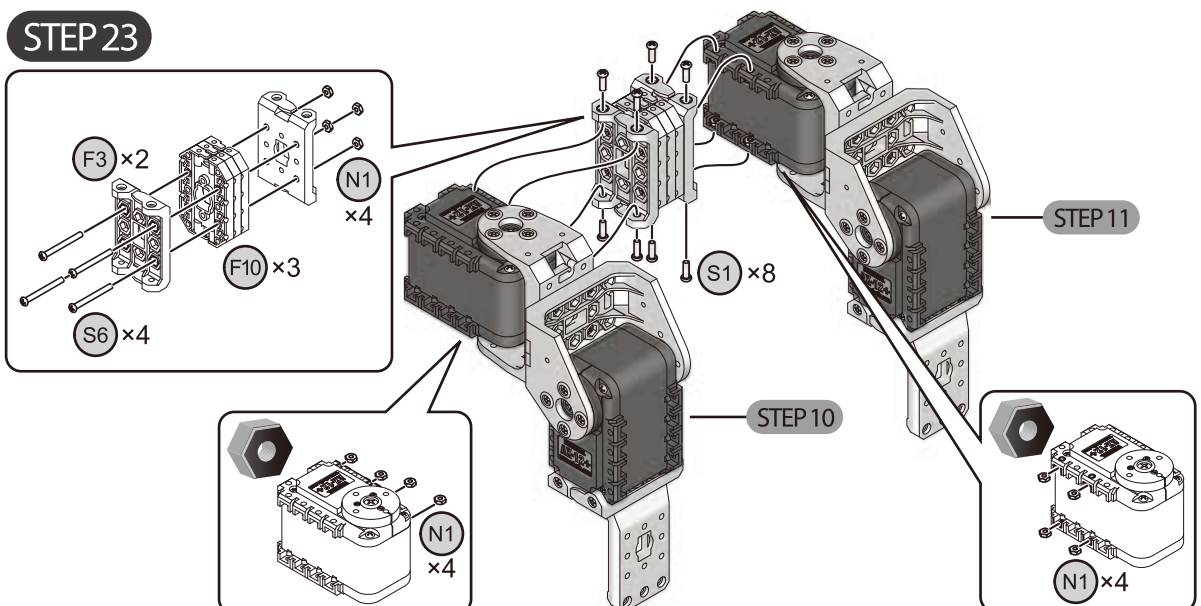

STEP 24

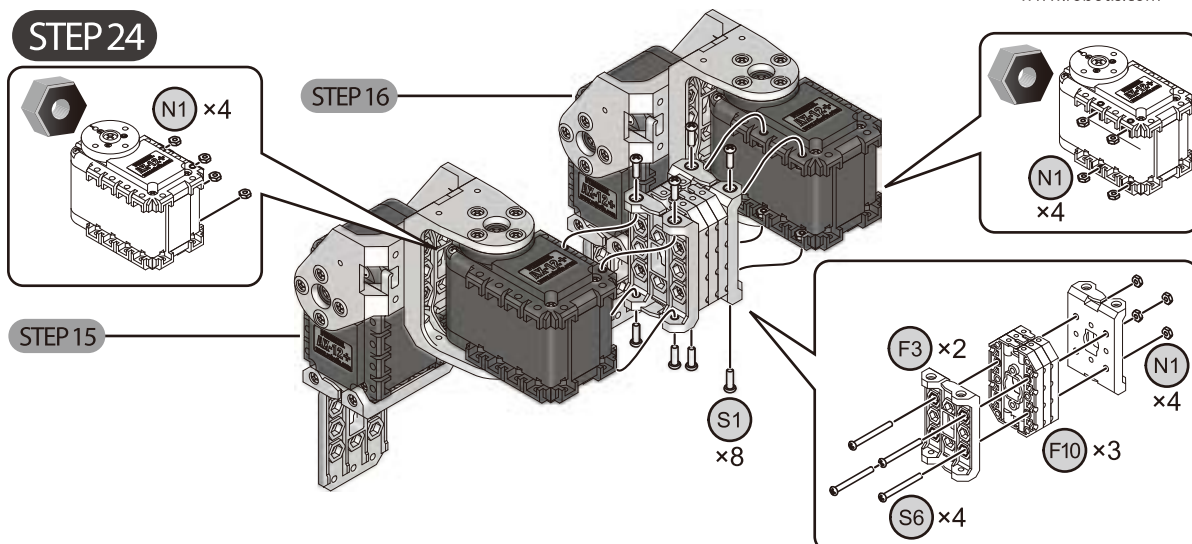

STEP 25

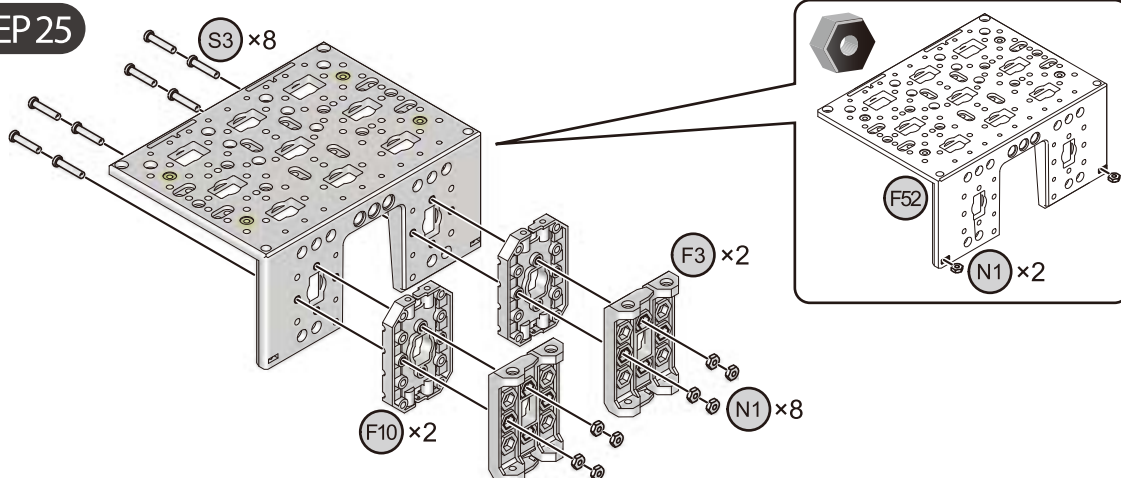

STEP 26

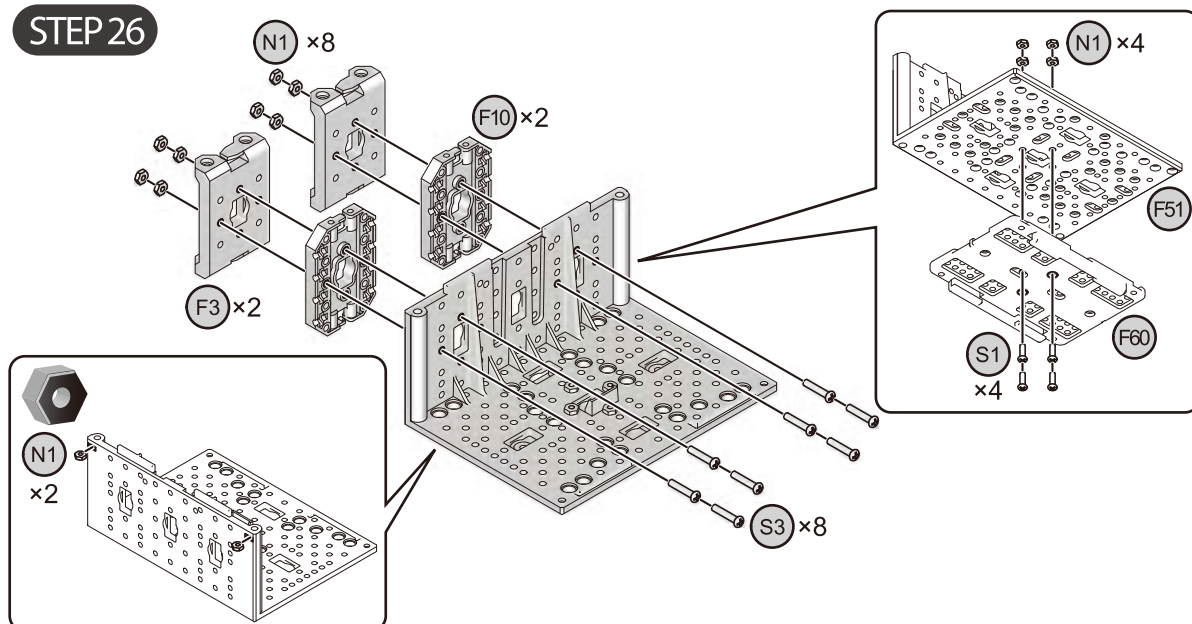

STEP 27

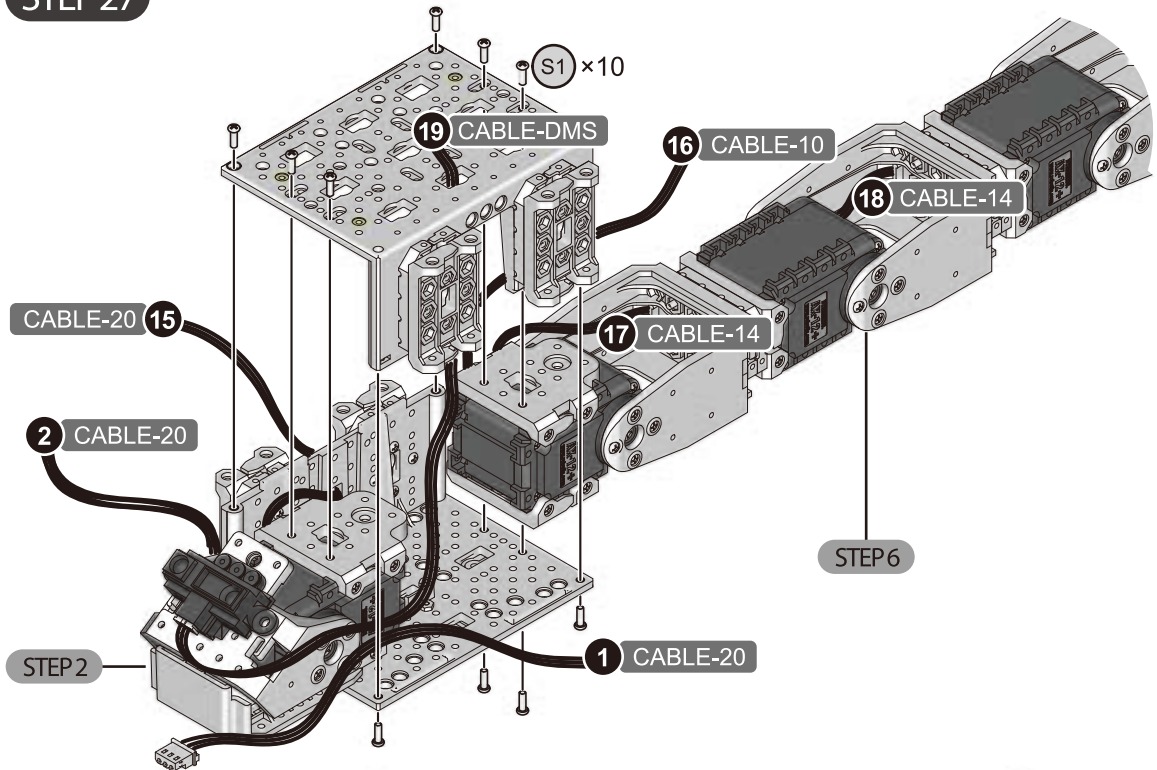

STEP 28

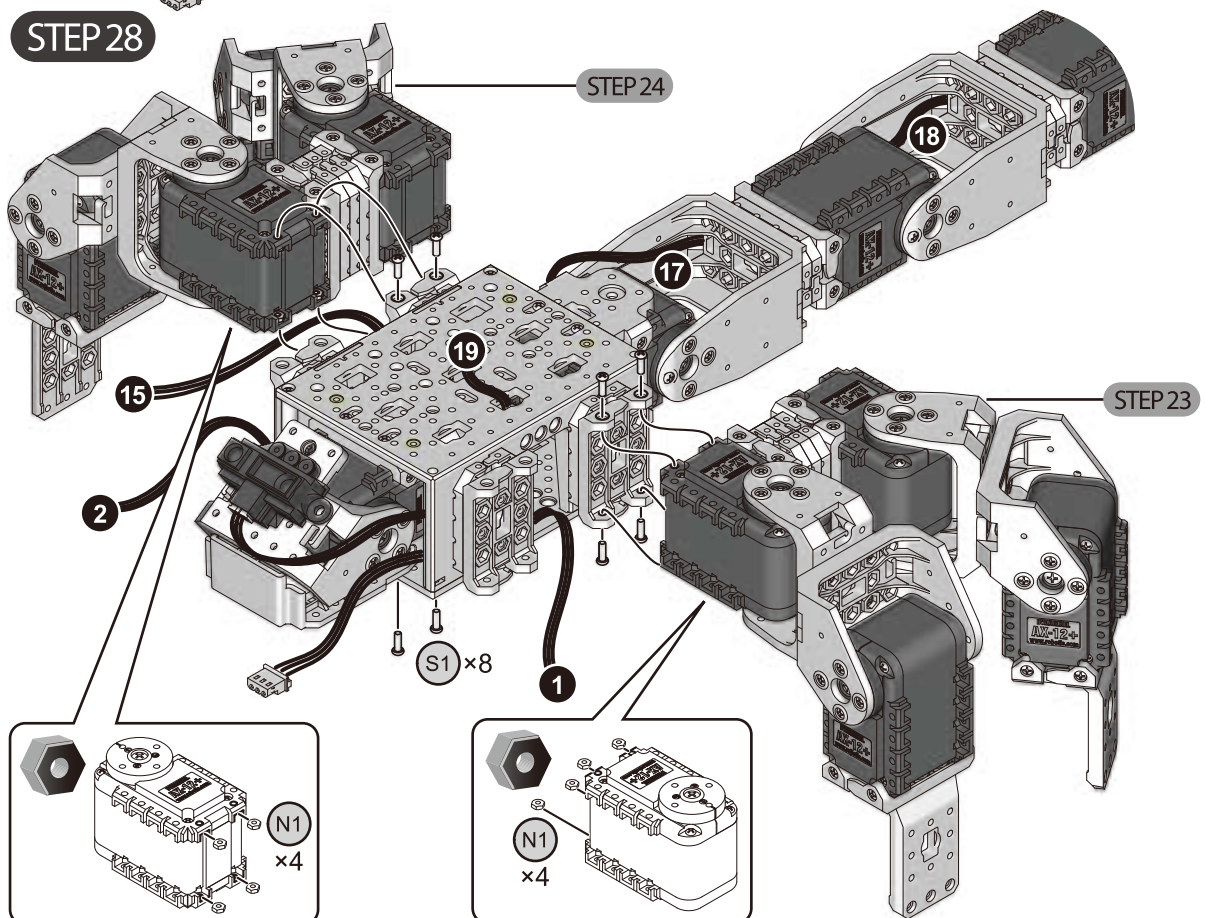

STEP 29

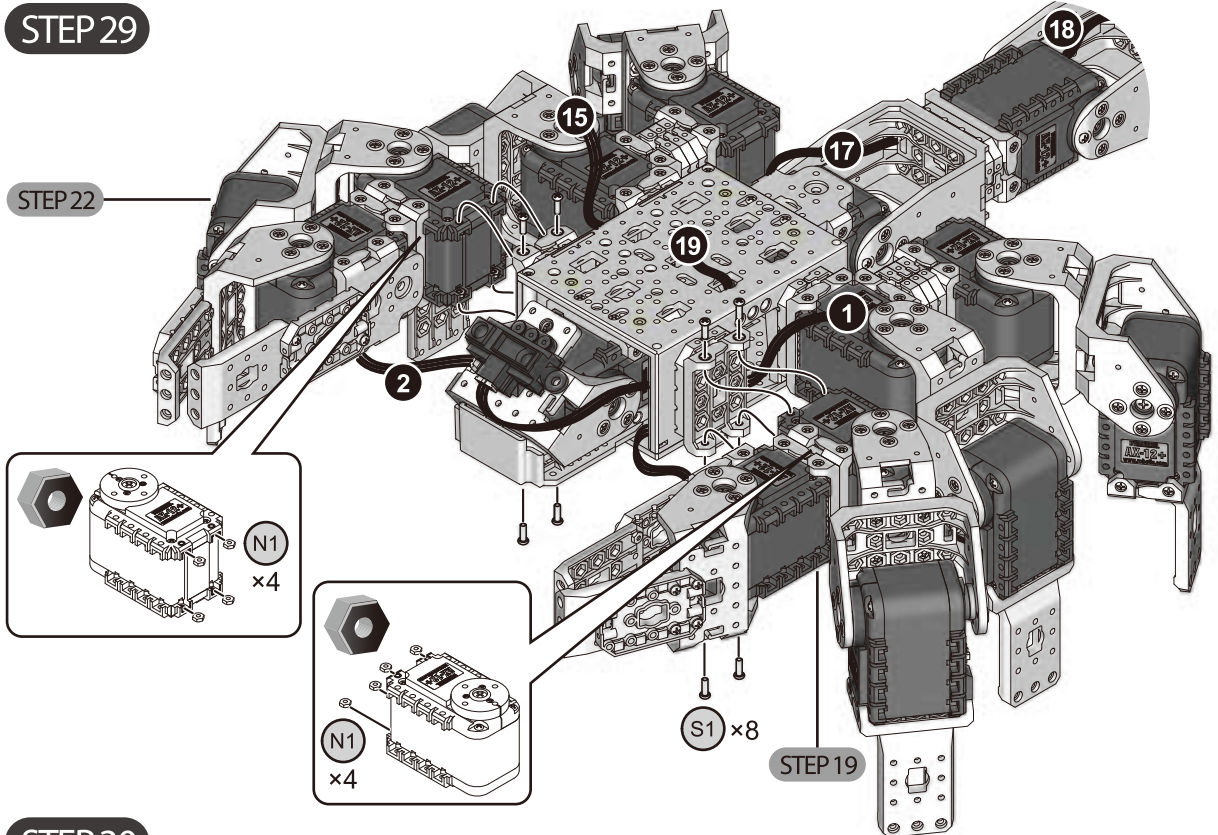

STEP 30

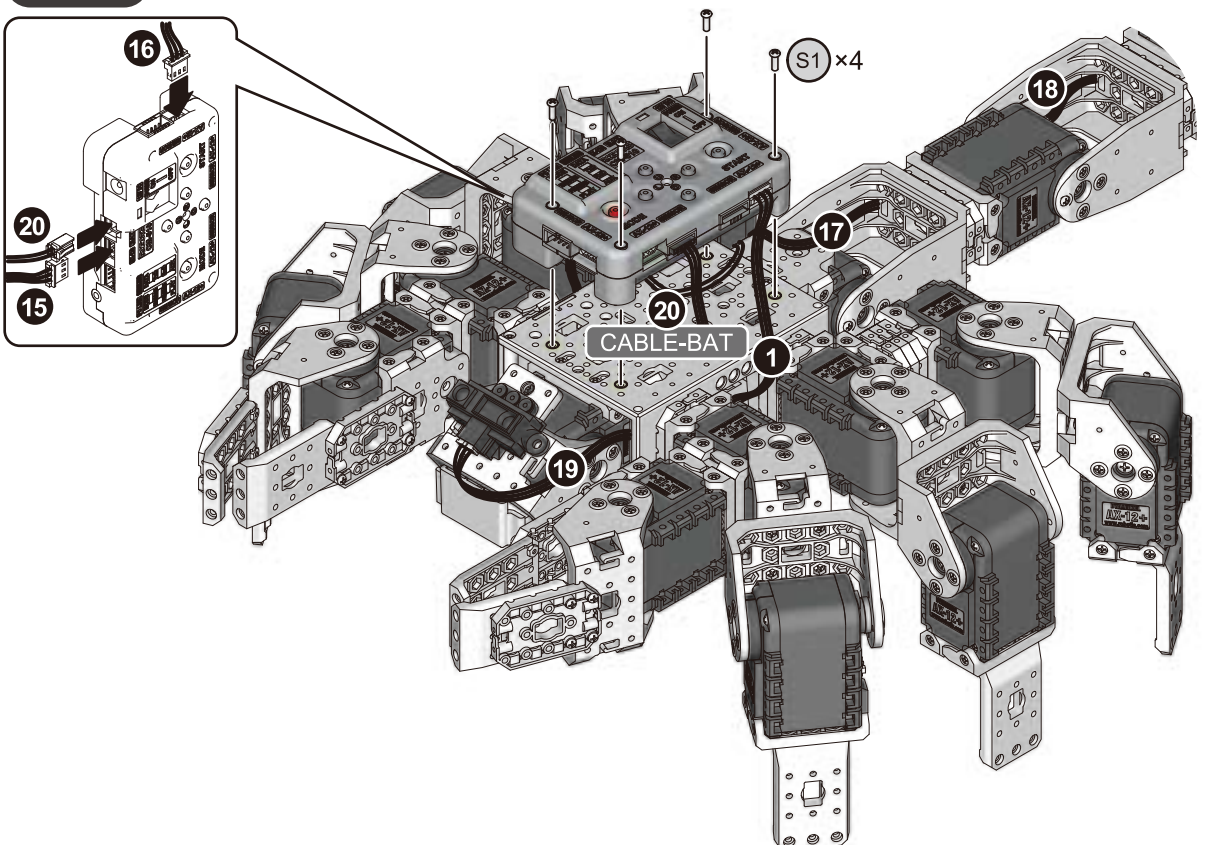

STEP 31

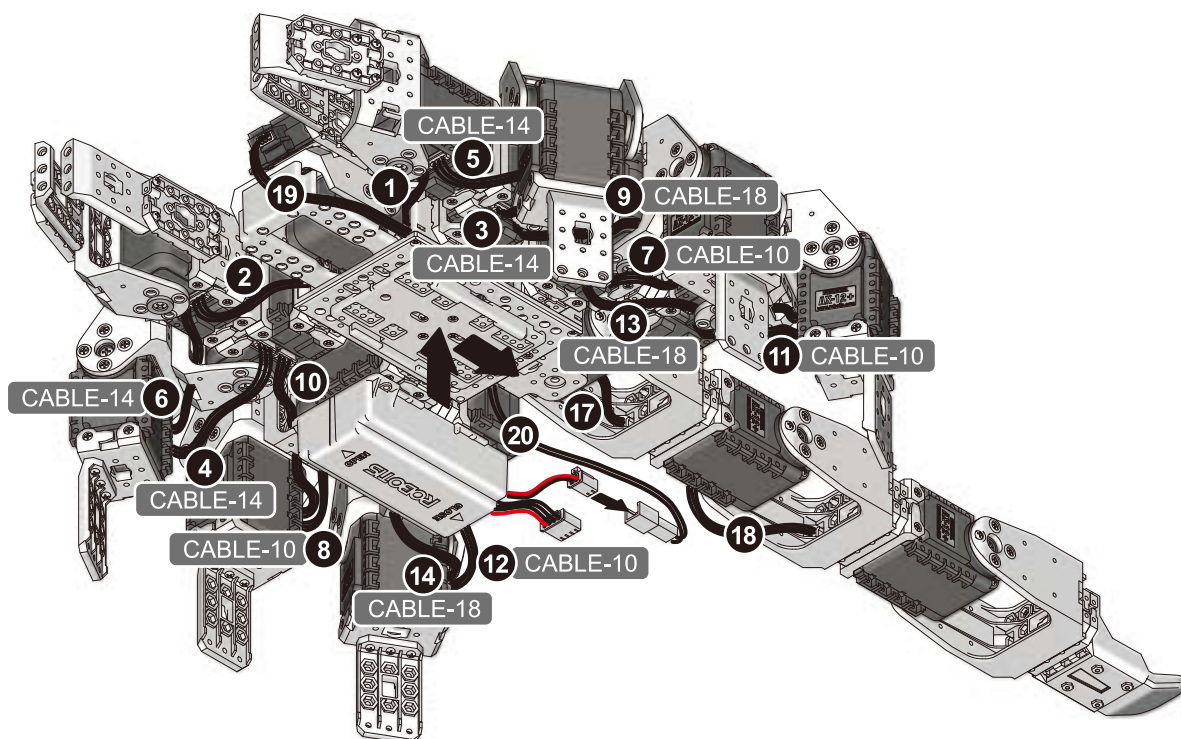

ID 1 motor	◀ 1 CABLE-20 ▶	CM-510	ID 11 motor	◀ 11 CABLE-10 ▶	ID 13 motor
ID 2 motor	◀ 2 CABLE-20 ▶	ID 15 motor	ID 12 motor	◀ 12 CABLE-10 ▶	ID 14 motor
ID 3 motor	◀ 3 CABLE-14 ▶	ID 5 motor	ID 13 motor	◀ 13 CABLE-18 ▶	ID 7 motor
ID 4 motor	◀ 4 CABLE-14 ▶	ID 6 motor	ID 14 motor	◀ 14 CABLE-18 ▶	ID 8 motor
ID 5 motor	◀ 5 CABLE-14 ▶	ID 1 motor	ID 15 motor	◀ 15 CABLE-20 ▶	CM-510
ID 6 motor	◀ 6 CABLE-14 ▶	ID 2 motor	ID 16 motor	◀ 16 CABLE-10 ▶	CM-510
ID 7 motor	◀ 7 CABLE-10 ▶	ID 9 motor	ID 17 motor	◀ 17 CABLE-14 ▶	ID 16 motor
ID 8 motor	◀ 8 CABLE-10 ▶	ID 10 motor	ID 18 motor	◀ 18 CABLE-14 ▶	ID 17 motor
ID 9 motor	◀ 9 CABLE-18 ▶	ID 3 motor	DMS	◀ 19 5P-CABLE 15 ▶	CM-510 PORT 3
ID 10 motor	◀ 10 CABLE-18 ▶	ID 4 motor	BAT	◀ 20 CABLE-BAT ▶	CM-510

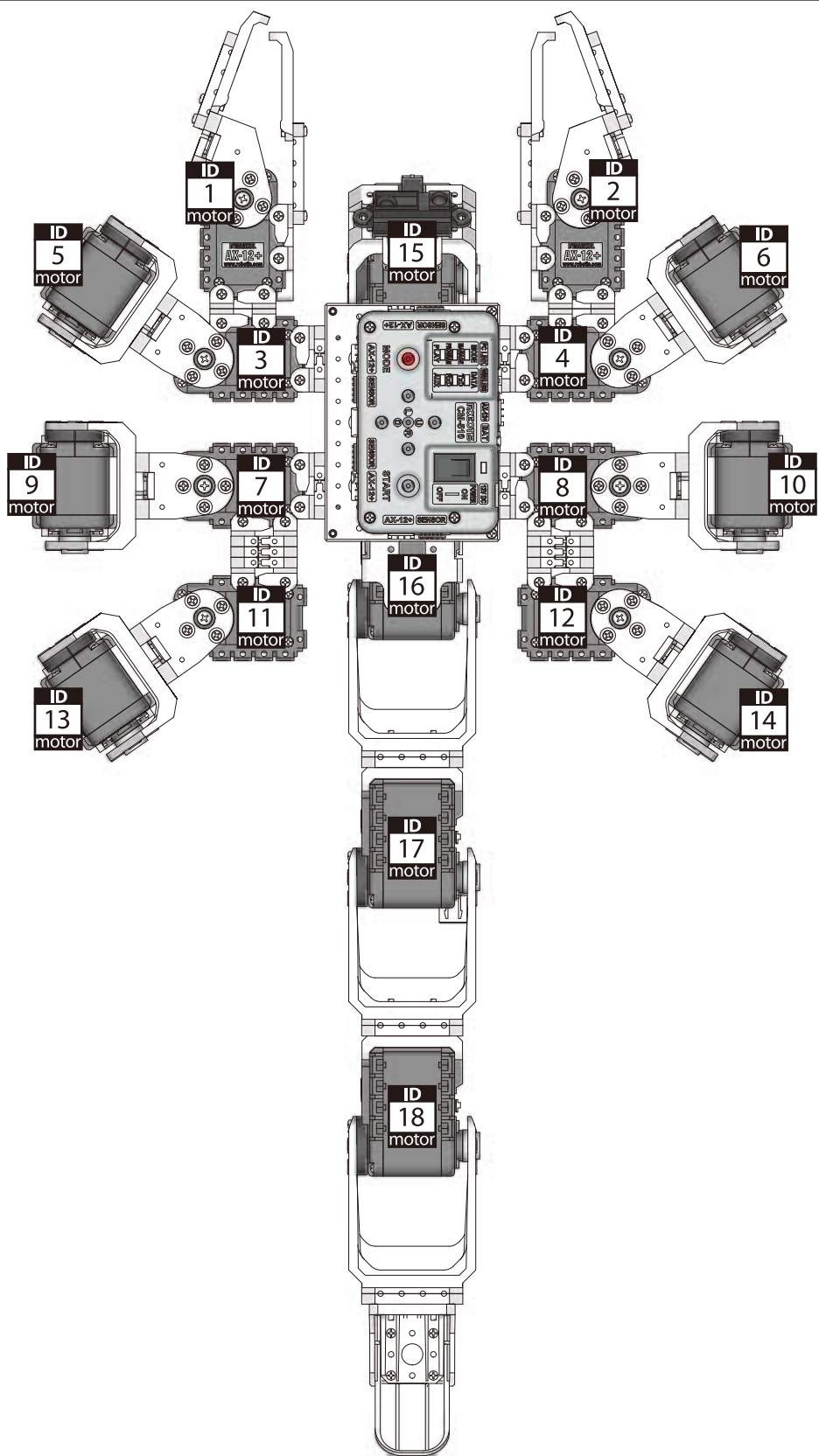

Assembly Check

After assembly please check the following procedure to ensure correctness.

STEP 1

Run the assembly check program

Set the robot in **PLAY** mode; hold the **D** button then press **START**.

Once the **START** button is pressed, the assembly check program begins.

STEP 2

AX12+ initial position and ID check

Select each actuator separately and compare it to the picture below.

Ensure the actuators' horns are properly aligned (the horn's notch should be aligned with the actuator's).

Pressing the **U** or **D** button, selects one actuator at a time.

The selected actuator's LED lights up and goes to its initial position.

Check starts from ID1.

U moves to the next ID in ascending numerical order; **D**, in descending numerical order.

If the actuator's ID does not exist then the robot beeps.

Although the LED may lit, if there is no power, then check the wiring on the actuator.

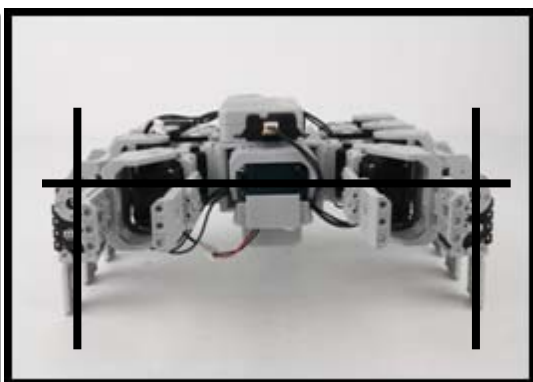
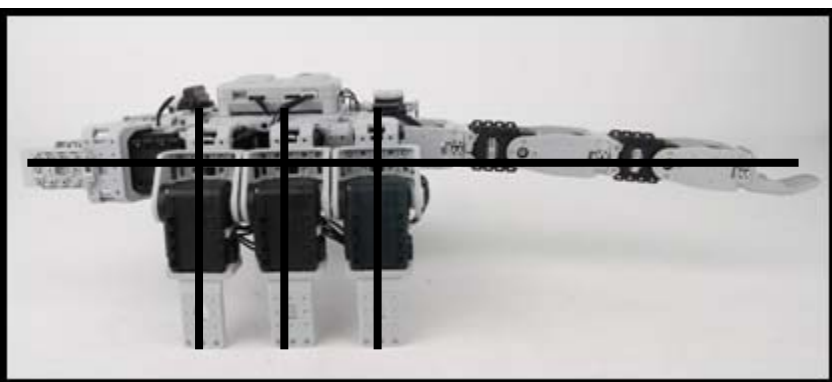
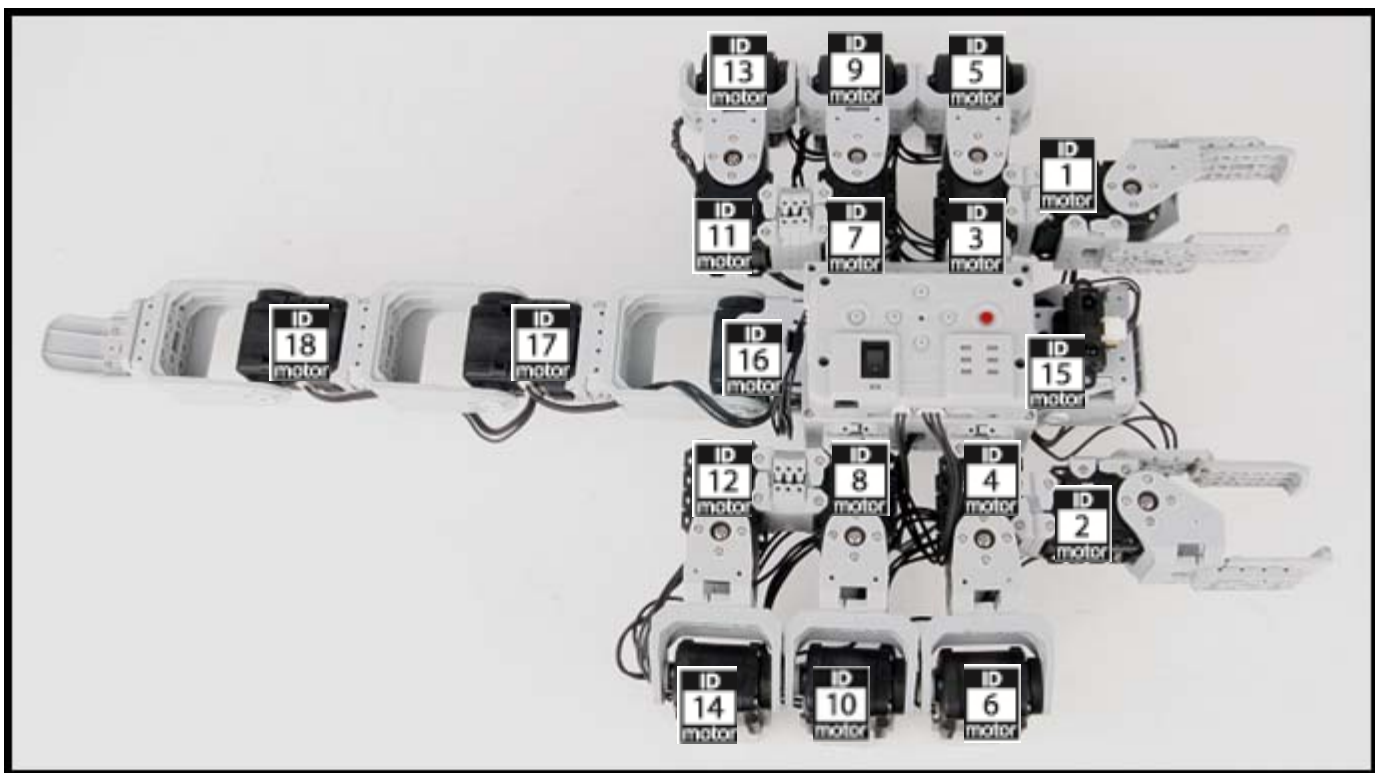

STEP 3

Sensor and behavior check

From STEP② press **R**. The robot returns to its initial position as pictured above. Place your hand close to the sensors, as pictured below. Robot behavior begins. If the robot does not behave, as pictured below, then check the sensor wiring and its port. Pressing **L** will return the robot back to STEP②.

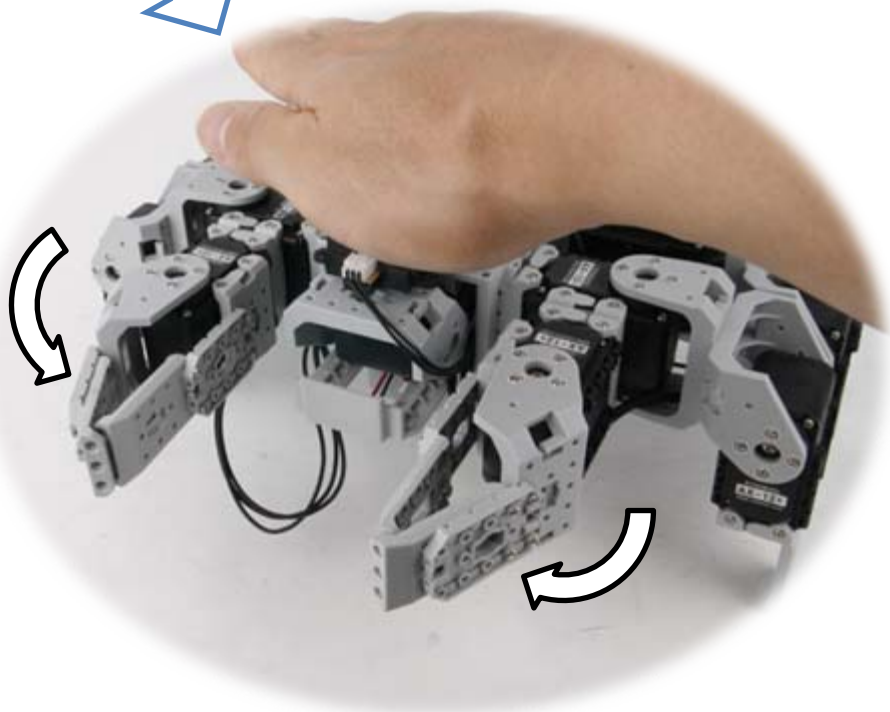

STEP 4

If everything works fine, play the robot.

Set the robot in **PLAY** mode. Press **START** and the robot will play.